

BENCH MARK:  
 IRM: TOP OF FH S.W. CORNER  
 LA JOLLA RANCHO RD & LA JOLLA SCENIC DR  
 EL. 548.39 CITY DATUM

SCALE:  
 HORIZ: 1" = 50'  
 VERT: 1" = 6'

0+00 ± BEGIN WORK  
 0+10 ± BEGIN CONTRACT

AS BUILT DATA  
 CONSTRUCTED BY: W.W. HUTCHISON CO. INC.  
 W.O. 12204 (CONSTR.), W.O. 48182 (ENGR.)  
 PIPE: 6" A.C. "J.M." RINGITE.  
 GATE VALVES: NONE  
 SOIL: GRANULAR  
 STAKED: 7-21-60 F.N. B-15  
 TESTED: 8-19-60, 225 P.S.I.  
 BACKFILL: SAME  
 CONNECTIONS BY: CITY FORCE  
 W.O. 12205  
 PIPE: 6" A.C.  
 GATE VALVES: UNAVAILABLE

REFERENCES:  
 WATER BOOK #2 - SHT. B-11-D, B-12-A.  
 SEWER BOOK 7A - SHT. 1730, 1731  
 GAS BOOK 13 - SHT. 305A, 306A & B  
 GATE BOOK SHT. B 85  
 IMPROVEMENTS:  
 9507 & 08-L ABANDONED WATER MAIN IN LA JOLLA SCENIC DRIVE (PROP. CONSTR. DWGS)  
 11894-AL EXISTING 10" A.C. IN PL. 1256 & LA JOLLA SCENIC DRIVE  
 2741-D LA JOLLA RANCHO ROAD - SEWER CONSTR.

OPENINGS  
 4733-B, 4305-B, 16-27

RETIREMENT:  
 NONE

PL. 1256 PL. 1774

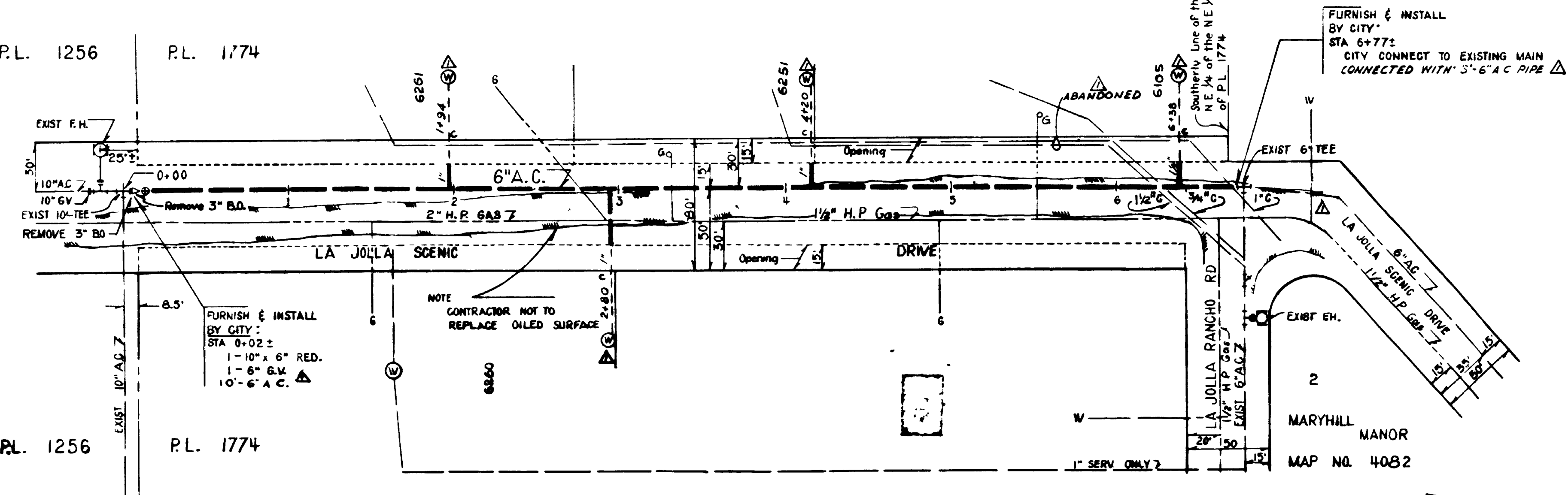

FURNISH & INSTALL  
 BY CITY:  
 STA 0+02 ±  
 1- 10" x 6" RED.  
 1- 8" G.W. Δ  
 10- 6" A.C.

NOTE:  
 CONTRACTOR NOT TO  
 REPLACE OILED SURFACE

NOTE:  
 CONTRACTOR TO LOCATE  
 CONNECTIONS PRIOR TO TRENCHING

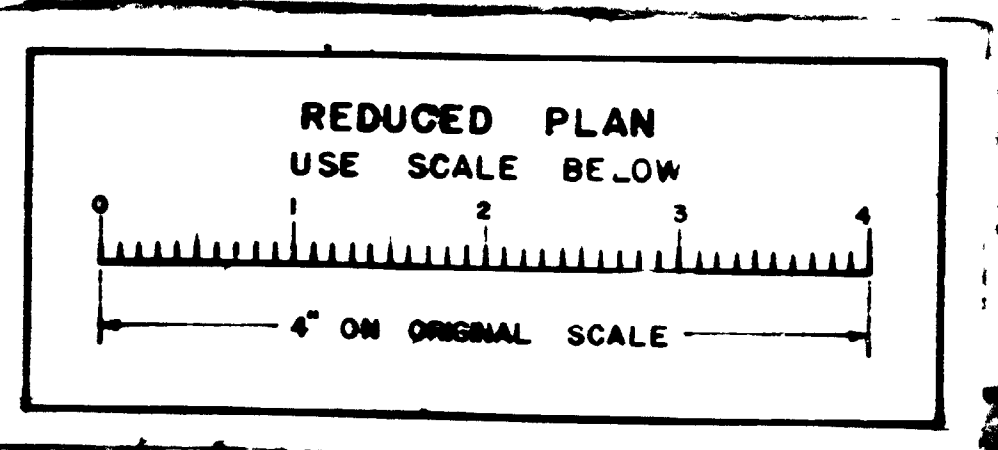

SCALE: 1" = 50'

GROUP 220		ENGR. W.O. 48182
LA JOLLA SCENIC DRIVE 6" A.C. MAIN		
PUEBLO LOT 1256 (EASEMENT NORTH) TO LA JOLLA RANCHO ROAD		
CITY OF SAN DIEGO ENGINEERING DEPARTMENT		8925-W
SHEET 13 OF 13 SHEETS		
PLAN REVISION	DATE	APPROVAL
AS BUILT PER M.P.S. 1/23/61		
APPROVALS FOR		CITY ENGINEER
WATER DEPT.	SEWERAGE	
PLANNING DEPT.	DRAINAGE	
CONSTRUCTION RECORD		
DATE STARTED	DATE COMPLETED	
7-2-60	8-18-60	
CONTR. SEC. AS-246	INSPECTION TRAVELER	
FIELD BOOK B-11-12: LA JOLLA SCENIC DR.		
APPROVALS FOR		ASST. CITY ENGINEER AND OFFICE ENGINEER
ELECTRICAL	HIGHWAY	
STRUCTURAL	GRADES	
TRAFFIC	CONTROL	
SUPERVISOR		MARSHALL - KLEE
CHECKED		KLEE DLOGETI
DESIGNED		3-15-60
		9582-D

AS BUILT

LA JOLLA SCENIC DRIVE