

WORK TO BE DONE

The improvement consists of the following work to be done according to these plans and the specifications hereto attached:

The construction of vitrified clay pipe sewer main as shown thus: $\text{---} \text{---} \text{---}$ 6" V.C.

The construction of vitrified clay extra strength pipe sewer main as shown thus: $\text{---} \text{---} \text{---}$ 6" V.C.E.S.

The construction of concrete manholes as shown thus: $\text{---} \text{---} \text{---}$ MH No. 1

The construction of concrete cradle as shown thus: $\text{---} \text{---} \text{---}$

The construction of concrete encasement as shown thus: $\text{---} \text{---} \text{---}$

The construction of vitrified clay pipe sewer chimneys as shown thus: $\text{---} \text{---} \text{---}$ 6" 4' x 6"

EXISTING WORK

Manholes	$\text{---} \text{---} \text{---}$	Gas Mains	$\text{---} \text{---} \text{---}$ 2" H.P.
Sanitary Sewer Mains	$\text{---} \text{---} \text{---}$ 6" C.I.	Gas Service Connections	$\text{---} \text{---} \text{---}$ G
Water Mains	$\text{---} \text{---} \text{---}$ 6" C.I.	Telephone Conduits	$\text{---} \text{---} \text{---}$ T
Fire Hydrants	$\text{---} \text{---} \text{---}$ F.H.	Telephone Service Conduits	$\text{---} \text{---} \text{---}$ T
Water Service Connection	$\text{---} \text{---} \text{---}$ W	Electrical Power Conduits	$\text{---} \text{---} \text{---}$ E
Pavement Edge	$\text{---} \text{---} \text{---}$ 4"	Electrical Power Service Conduits	$\text{---} \text{---} \text{---}$ E
Bush	$\text{---} \text{---} \text{---}$ 4"	Cobblestone Gutter	$\text{---} \text{---} \text{---}$

REFERENCE DRAWINGS

7421-L	11008-L	M-32	100-5-B (6-1-53)	107-5-B
7422-L	11018-L	3499-Roll	101-5-B (6-1-53)	108-5-B
7423-L		4624-B	105-5-B (6-1-53)	110-5-B (6-1-53)
			110-5-B	120-5-B (6-1-53)

STANDARD DRAWINGS

LEGEND

V.C. means Vitrified Clay	P.C.C. means Portland Cement Concrete	C.I. means Cast Iron
E.S. - Extra Strength	A.C. - Asphalt Concrete	E. - Electrical
M.H. - Manhole	EI - Elevation	F.D. - Fiber Duct
Sta. - Station	H.P. - High Pressure	Conc. - Concrete
Dwg. - Drawing	T.A.C. - Transite Asbestos Cement	

GENERAL NOTES

- Where pavement or surfacing is removed or damaged in the construction of the sewer trenches it shall be replaced to as near its original location and elevation as is reasonably possible as noted below and in typical sections on Sheet 3.
- Where cobblestone gutter is removed or damaged extensively it shall be replaced in accordance with Typical Section on Sheet 3.
- Where pipe is laid on curves, the deflection per joint shall not exceed 2".

West Muirlands Drive --- replace with 6" P.C.C. Base Course and 1" A.C. Surface Course
Muirlands Drive --- 6" P.C.C.
P.C.C. Driveway --- 6" P.C.C.
Macadam, or not shown --- in like kind and thickness

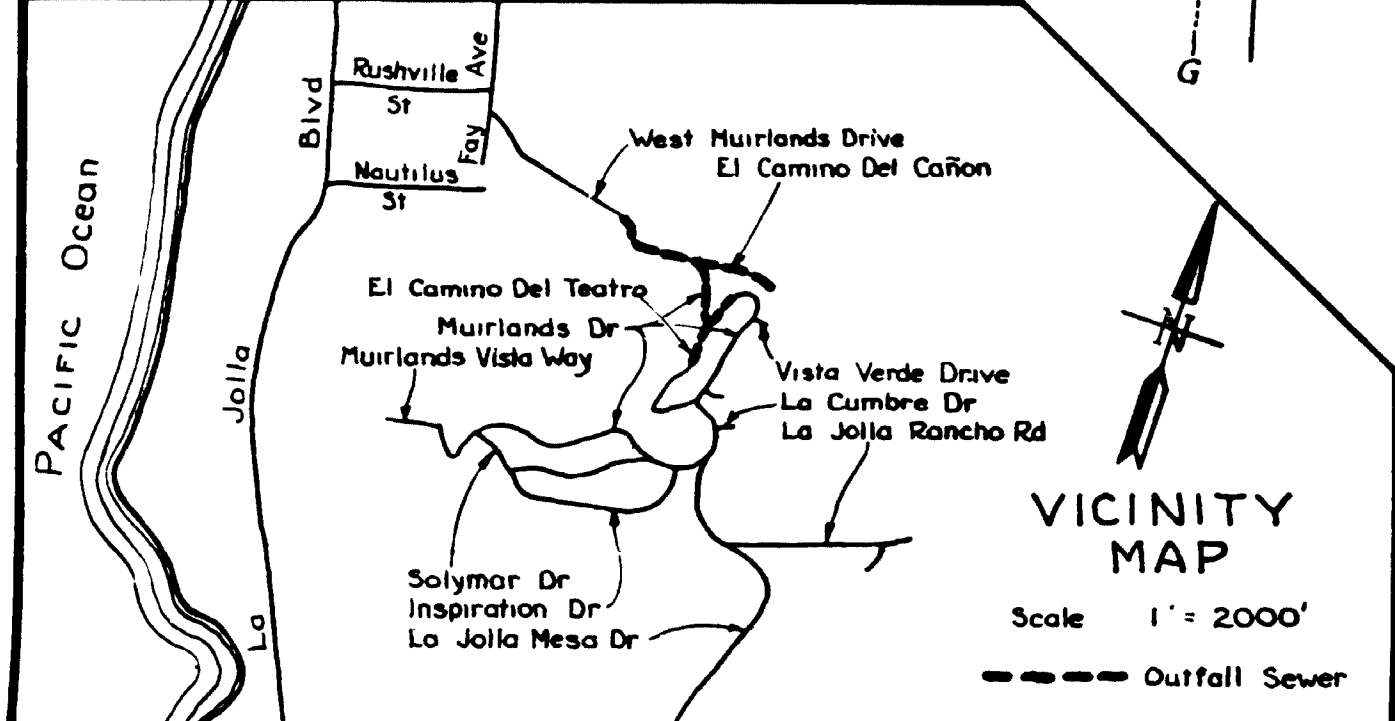
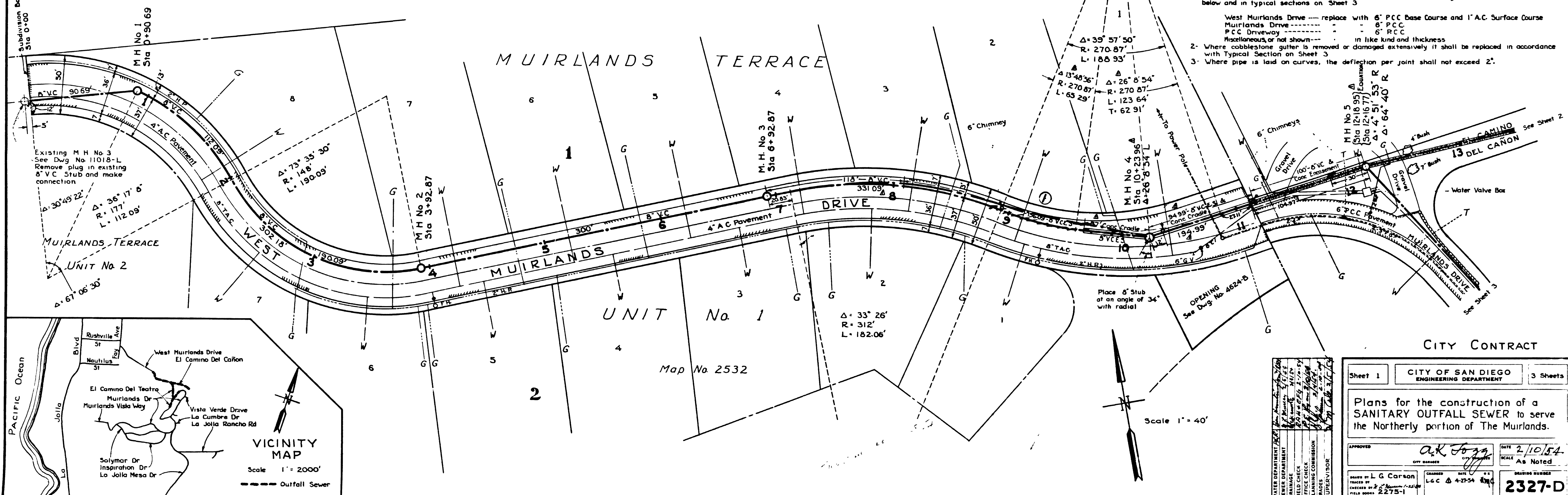

CITY CONTRACT

Sheet 1 CITY OF SAN DIEGO ENGINEERING DEPARTMENT 3 Sheets

Plans for the construction of a SANITARY OUTFALL SEWER to serve the Northerly portion of The Muirlands.

APPROVED: *A.K. Foy* DATE: 2/10/54
CITY ENGINEER: *[Signature]* SCALE: As Noted

MADE BY: L.G. CARROLL
CHECKED BY: *[Signature]*
DESIGNED BY: *[Signature]*
FIELD CHECK: *[Signature]*
OFFICE CHECK: *[Signature]*
IN CHARGE: *[Signature]*
SUPERVISOR: *[Signature]*

CONSTRUCTION RECORD
CONTRACTOR: *Camden Bros*
DATE STARTED: *2-11-54*
DATE COMPLETED: *6-16-54*
PROJECT NO.: *2275-1*
DRAWING NO.: *2327-D*

REDUCED PLAN USE SCALE BELOW

0 1 2 3 4
4" ON ORIGINAL SCALE