

SEWER MAIN RELOCATIONS I-805
0.1 MI. N'LY OF IMPERIAL AVE. TO 0.1 MI. S'LY OF ROUTE 94

Dist	County	Route	Post Miles Total Project	Sheet No	Total Sheets
DESIGN ENGINEER			REGISTERED CIVIL ENGINEER		
			NO		
DATE APPROVED					

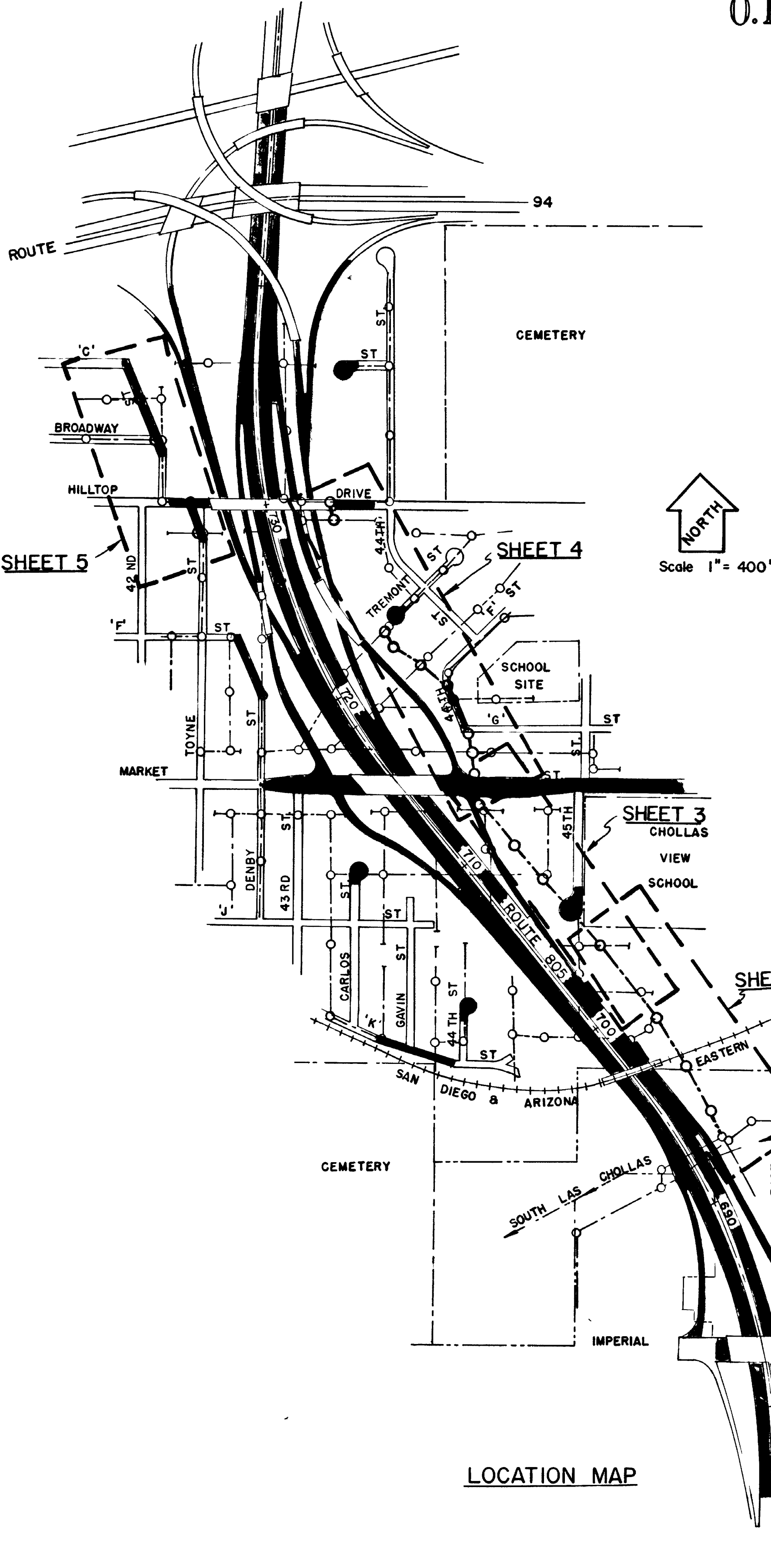

GENERAL NOTES

- 1 THE LOCATIONS OF EXISTING SERVICES SHOWN ON THESE DETAILED PLANS ARE APPROXIMATE. ACTUAL LOCATIONS SHALL BE DETERMINED BY THE CONTRACTOR IN THE FIELD
- 2 ALL UTILITY AGENCIES SHALL BE NOTIFIED BY CONTRACTOR PRIOR TO BEGINNING CONSTRUCTION ON THIS PROJECT
- 3 THE CONTRACTOR SHALL PROVIDE LATERAL AND VERTICAL SUPPORT FOR EXISTING WATER MAIN WHERE REQUIRED TO PREVENT LOSS OF FUNCTION
- 4 THE BOTTOMS OF EXISTING MANHOLES SHALL BE RECHANNELED TO ACCOMMODATE NEW CONNECTIONS

TRAFFIC REQUIREMENTS

REFERENCE TO SECTION 1.22 OF STANDARD SPECIFICATIONS
1 MAINTAIN A MINIMUM OF ONE LANE IN EACH DIRECTION ON MARKET STREET AT ALL TIMES

RETIREMENT

LENGTH	SIZE & TYPE	DWG NO	YR INSTALLED
45' LIN FT	8" V C	10071-D	1961
1480' "	" "	13109-L	1957
105' "	" "	12615-L	1956
113' "	" "	100' Scale	1953
2,544' "	" "	13765-L	1942
594' "	" "	13109-L	1942
300' "	" "	9991-I-L	1941
520' "	" "	100' Scale	1953
264' "	" "	8889-L	1951
194' "	" "	3917-B	1950
230' "	" "	7792-L	1949
2,580' "	" "	13765-L	1942
889' "	" "	9991-I-L	1941
859' "	6" CONC	14539-44-L	1927

WORK TO BE DONE SCHEDULE
IMPROVEMENT CITY of SAN DIEGO
STANDARD DRAWING

LEGEND
VITRIFIED CLAY SEWER MAIN S-1 12" V C
CONCRETE MANHOLES S-8, M-23
CONCRETE CRADLE S-3
CONCRETE ENCASEMENT S-5
SEWER LATERAL CONNECTION S-22

CITY OF SAN DIEGO STANDARD SPECIFICATIONS, DOCUMENT NO 727731, FILED 4-14-69
CITY OF SAN DIEGO STANDARD DRAWING, DOCUMENT NO 735691, FILED 4-26-71
STATE OF CALIFORNIA, DEPARTMENT OF PUBLIC WORKS, DIVISION OF HIGHWAYS STANDARD SPECIFICATIONS DATED JANUARY 1971
SPECIAL PROVISIONS

DATUM - MEAN SEA LEVEL

REFERENCE DRAWINGS - SEE PLANS

FIELD NOTES 196-1740 (BEATTY) APRIL 20, 1972

"AS BUILT"
CALTRANS CONTRACT 148314
YEAR COMPLETED 9-9-75

Design Engineer
Date
Approved Recommended By
Date
Project Engineer
Date

BEFORE EXCAVATING, VERIFY LOCATION OF UNDERGROUND UTILITIES - CONTACT
GAS & ELECTRIC CO 232-4252, EXT 1658
TELEPHONE CO 298-0595
WATER & SEWER 236-5650
BLDGs & ELECT 236-5505
FIRE ALARM 234-6154

APPROVALS	
DEPARTMENTAL PLANNING	ENG. DEPT. DIVISION OR SECTION
PROPERTY	ELECTRICAL
PUBLIC WORKS	FIELD CHECK
RECREATION	GRADES AND DRAINS
UTILITIES	HIGHWAYS
STRUCTURAL	MONUMENTS
TRAFFIC	PARKS
WATER	SEWERAGE
	STREET ACTIONS

SEWER RELOCATION - I-805 IMPERIAL AVE TO ROUTE 94			
CITY OF SAN DIEGO, CALIFORNIA UTILITIES DEPARTMENT SHEET 1 OF 5 SHEETS		EWO 147016 UWO 60881	
APPROVED BY <i>[Signature]</i> DATE 12/1/72		APPROVED BY <i>[Signature]</i> DATE 12/1/72	
DESCRIPTION	BY	APPROVED	FILMED
ORIGINAL	Carson	COBURN	12-16-72
AS BUILT	FULLER	12-16-72	12-16-72
CONSTRUCTION RECORD		CONTROL CERTIFICATION	
CONTRACTOR DATE STARTED		196-1740	
INSPECTOR DATE COMPLETED		LAMBERT COORDINATES	
CONNECTIONS BY		15391-I-D	

AS BUILT